



GOVERNORS

Line Pressure Regulators

GOVERNOR

Line Pressure Regulators

Introduction

Pietro Fiorentini's GOVERNOR line of gas regulators are designed to comply with the latest CSA and international standards for regulators suitable for indoor and outdoor installations with no modifications.

The GOVERNOR family of regulators are ideal for a wide range of residential through large industrial applications. The materials and soft parts used in the construction of the GOVERNOR regulators make them suitable for use with natural gas, LPG, Propane air and all other non-corrosive gases.

All the GOVERNOR regulators are equipped with balanced valve design for high outlet pressure accuracy regardless of any Inlet pressure variation. The double diaphragm and integral vent limiter provides added security in case of primary diaphragm failure. The external vent limiter eliminates the need for costly piping for indoor installations and complies with CSA guidelines.* The number of regulator options sometimes eliminates the need for separate units and significantly reduces installation costs.

Safe, Reliable and High Performance

- Internal vent limiter: non removable, for indoor and outdoor installations.
- External vent limiter for indoor installations.*
- Double diaphragm for added safety and greater reliability of service.
- Balanced valve design gives you for increase capacity, high 500 to 1 turndown and stable regulation from low to high flow.
- Complete lockup in absence of gas flow, bubble tight shutoff.

**As Approved by Local Codes and Standards*

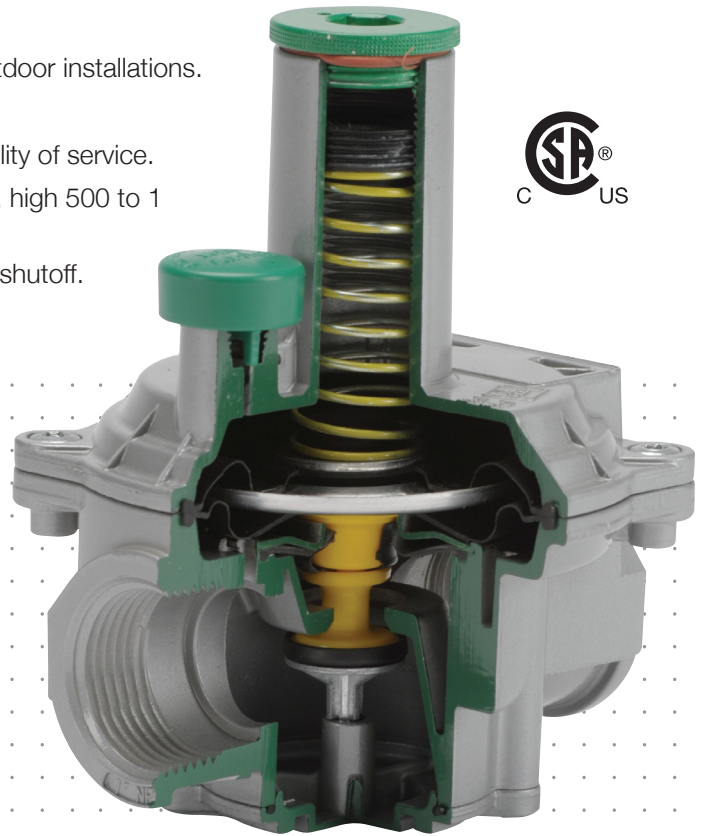

SINGLE MODEL

Inlet Pressure Range: 25" W.C. to 2 PSIG

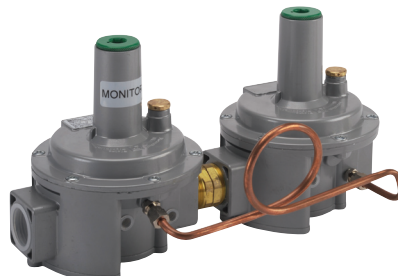

OVER PRESSURE DEVICE (OPD) MODEL

Inlet Pressure Range: 25"W.C. to 5 PSIG



SLAM SHUT MODEL

Inlet Pressure Range: 25"W.C. to 5 PSIG

GOVERNOR Standard Model



STANDARD MODEL
Inlet Pressure Range: 25" W.C. to 2 PSIG

Main Features

- CSA 6.22a-2005 ANSI Z21.80A2005 Class I for outlet pressures up to 14" W.C. Certified
- Integral Vent Limiter
- External Vent Limiter — no vent line required*
- Positive dead-end lockup
- Inlet and Outlet test ports
- 500 to 1 Turndown
- Minimum ΔP – 1" W.C.

Specifications

- Suitable for use with Natural Gas, LPG, and any non corrosive clean gas
- Inlet pressure: 3" W.C. to 2 PSIG
- Outlet pressure: 2" W.C. to 14" W.C.
- Temperature range: -40F to 150F
- Connections: ½" thru 4"
- Maximum Emergency Inlet Exposure Pressure: 80 PSIG
- Suitable for Indoor or Outdoor Installation

**As Approved by Local Codes and Standards*

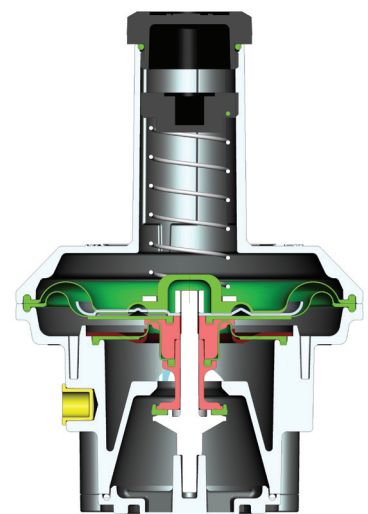

Standard Outlet Spring Range

- Green 2" W.C. to 5.1" W.C.
- Red 2.75" W.C. to 7.87" W.C.
- White 4" W.C. to 11.8" W.C.
- Black 6" W.C. to 14" W.C.

GOVERNOR

Line Pressure Regulators

GOVERNOR CAPACITY IN CFH FOR .60 SPECIFIC GRAVITY GAS

	Outlet Pressure Set Point	Operating Inlet Pressure	
		1 PSIG	2 PSIG
30051 1/2"	8" W.C.	635	928
	11" W.C.	628	928
	Outlet Pressure Set Point	Operating Inlet Pressure	
		1 PSIG	2 PSIG
30052 3/4"	8" W.C.	848	1,155
	11" W.C.	778	1,155
	Outlet Pressure Set Point	Operating Inlet Pressure	
		1 PSIG	2 PSIG
30053 1"	8" W.C.	1,059	1,501
	11" W.C.	1,093	1,501
	Outlet Pressure Set Point	Operating Inlet Pressure	
		1 PSIG	2 PSIG
30150 1/2" High Capacity	8" W.C.	1,695	2,205
	11" W.C.	1,471	2,213
	Outlet Pressure Set Point	Operating Inlet Pressure	
		1 PSIG	2 PSIG
30151 3/4" High Capacity	8" W.C.	2,084	2,785
	11" W.C.	1,858	2,796
	Outlet Pressure Set Point	Operating Inlet Pressure	
		1 PSIG	2 PSIG
30152 1" High Capacity	8" W.C.	2,437	3,308
	11" W.C.	2,206	3,320
	Outlet Pressure Set Point	Operating Inlet Pressure	
		1 PSIG	2 PSIG
30153 1 1/4"	8" W.C.	5,297	7,891
	11" W.C.	5,264	7,891
	Outlet Pressure Set Point	Operating Inlet Pressure	
		1 PSIG	2 PSIG
30154 1 1/2"	8" W.C.	5,650	8,240
	11" W.C.	5,496	8,270
	Outlet Pressure Set Point	Operating Inlet Pressure	
		1 PSIG	2 PSIG
30155 2"	8" W.C.	10,947	15,087
	11" W.C.	10,064	15,143
	Outlet Pressure Set Point	Operating Inlet Pressure	
		1 PSIG	2 PSIG
30157/F 3"	8" W.C.	16,810	23,202
	11" W.C.	15,715	23,308
	Outlet Pressure Set Point	Operating Inlet Pressure	
		1 PSIG	2 PSIG
30158/F 4"	8" W.C.	29,452	40,612
	11" W.C.	27,545	40,753

GOVERNOR

Over Pressure Device (OPD) Model



OVER PRESSURE DEVICE (OPD) MODEL
Inlet Pressure Range: 25" W.C. to 5 PSIG

Main Features

- CSA Certified to ANSI Z21.80A2005
- CSA 6.22a-2005 Class I for outlet pressures up to 14" W.C.
- CSA 6.22a-2005 Class II for outlet pressures up to 1 PSIG
- Integral Vent Limiter
- External Vent Limiter – no vent line required*
- Positive dead-end lockup
- Inlet and Outlet test ports
- 500 to 1 Turndown

Specifications

- Suitable for use with Natural Gas, LPG, and any non corrosive clean gas
- Inlet pressure: 7" W.C. to 5 PSIG
- Temperature range: -40F to 150F
- Connections: ½" thru 2"
- Maximum Emergency Inlet Exposure Pressure: 80 PSIG
- Suitable for Indoor or Outdoor Installation

**As Approved by Local Codes and Standards*

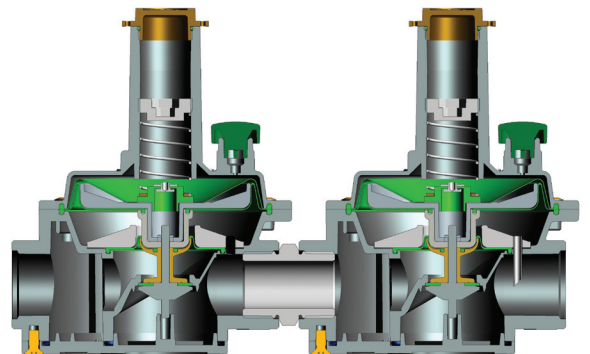

OPD Outlet Spring Range

- Green 2" W.C. to 5.1" W.C.
- Red 2.75" W.C. to 7.87" W.C.
- White 4" W.C. to 11.8" W.C.
- Black 6" W.C. to 14" W.C.
- Yellow 9.8" W.C. to 1 PSIG

GOVERNOR

Over Pressure Device (OPD) Model

GOVERNOR LINE PRESSURE REGULATOR WITH OVER PRESSURE DEVICE (OPD) CAPACITY IN CFH FOR .60 SPECIFIC GRAVITY GAS

	Outlet Pressure Set Point	Operating Inlet Pressure		
		1 PSIG	2 PSIG	5 PSIG
30051DC ½"	8" W.C.	635	928	928
	11" W.C.	628	928	928
	14" W.C.	558	936	936
30052 DC ¾"	8" W.C.	848	1,115	1,115
	11" W.C.	778	1,155	1,155
	14" W.C.	698	1,170	1,170
30053DC 1"	8" W.C.	1,059	1,501	1,501
	11" W.C.	1,093	1,501	1,501
	14" W.C.	906	1,521	1,521
30150DC ½" High Capacity	8" W.C.	1,695	2,205	2,205
	11" W.C.	1,471	2,213	2,213
	14" W.C.	1,325	2,223	2,223
30151DC ¾" High Capacity	8" W.C.	2,084	2,785	2,785
	11" W.C.	1,858	2,796	2,796
	14" W.C.	1,674	2,808	2,808
30152DC 1" High Capacity	8" W.C.	2,437	3,308	3,308
	11" W.C.	2,206	3,320	3,320
	14" W.C.	1,988	3,335	3,335
30153DC 1 ¼"	8" W.C.	5,297	7,891	7,891
	11" W.C.	5,264	7,921	7,921
	14" W.C.	4,743	7,957	7,957
30154DC 1 ½"	8" W.C.	5,650	8,240	8,240
	11" W.C.	5,496	8,270	8,270
	14" W.C.	4,952	8,308	8,308
30155DC 2"	8" W.C.	19,947	15,087	15,087
	11" W.C.	10,064	15,143	15,143
	14" W.C.	9,068	15,213	15,213
30157DC 3"	8" W.C.	16,810	23,202	23,202
	11" W.C.	15,715	23,308	23,308
	14" W.C.	13,768	23,406	23,406
30158DC 4"	8" W.C.	29,452	40,612	40,612
	11" W.C.	27,545	40,753	40,753
	14" W.C.	24,094	40,960	40,960

GOVERNOR

Standard Model - Dimension

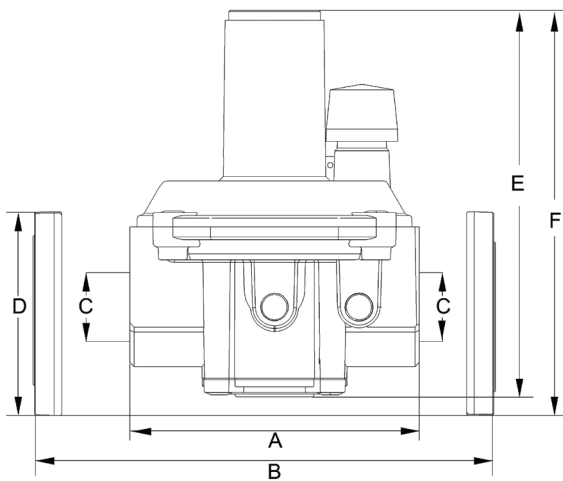

DIMENSIONS (IN INCHES)

Model #	Size	A	B	C	D	E	F	Weight (Lbs)
30151	1/2" NPT	4.12 4.45 w/Filter		1/2		5.59		1.54
30052	3/4" NPT	4 4.29 w/Filter		3/4		5.59		1.54
30053	1" NPT	4 4.29 w/Filter		1		5.59		1.54
30150	1/2" NPT	5.43		1/2		6.89		2.75
30151	3/4" NPT	5.28		3/4		6.89		2.75
30152	1" NPT	5.28		1		6.89		2.75
30153	1 1/4" NPT	7.64		1 1/4		10		7.5
30154	1 1/2" NPT	7.64		1 1/2		10		7.5
30155	2" NPT	9.29		2		12.44	13.74	12.34
30157/F	3" FLANGED		16.9	3	ANSI 150		17.09	27.56
30158/F	4" FLANGED		16.9	4	ANSI 150		19.76	27.56

GOVERNOR

Over Pressure Device (OPD) Model - Dimension

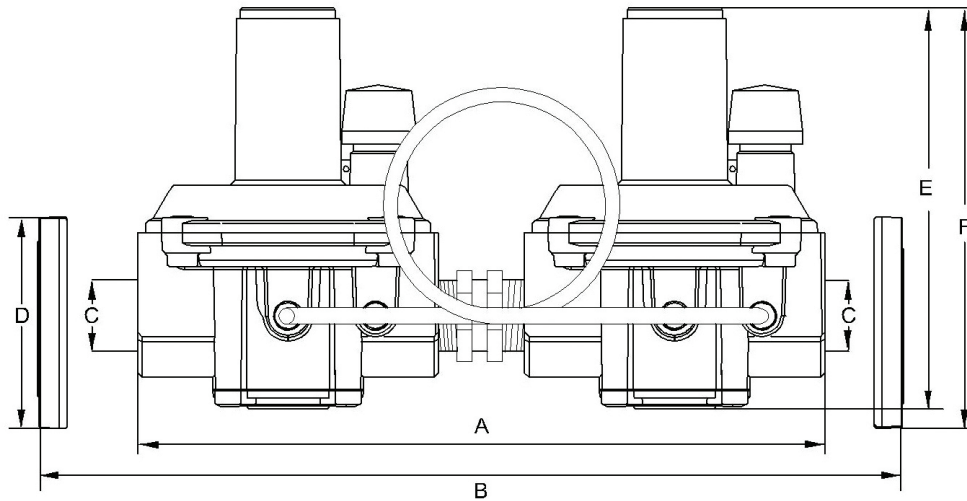

DIMENSIONS (IN INCHES)

Model #	Size	A	B	C	D	E	F	Weight (Lbs)
30151	1/2" NPT	8.86		1/2		5.59		3.25
30052	3/4" NPT	8.86		3/4		5.59		3.25
30053	1" NPT	8.86		1		5.59		3.25
30150	1/2" NPT	11.22		1/2		6.89		5.75
30151	3/4" NPT	11.22		3/4		6.89		5.75
30152	1" NPT	11.22		1		6.89		5.75
30153	1 1/4" NPT	16.61		1 1/4		10		15.5
30154	1 1/2" NPT	16.61		1 1/2		10		15.5
30155	2" NPT	19.88		2		12.44	13.74	25
30157/F	3" FLANGED		33.93	3	ANSI 150		17.09	56
30158/F	4" FLANGED		33.93	4	ANSI 150		19.76	56

Residential and Commercial Applications



DIVAL 500



FILTERS



NORVAL



Pietro Fiorentini USA
PO Box 728
Norcross, GA 30091

Fax: 770.448.7312
Toll-free: 888.618.8787

www.fiorentini.com www.gasinside.com

The data enclosed is not binding. We reserve the right to make eventual changes without prior notice.

CT-s581-US January 2011